

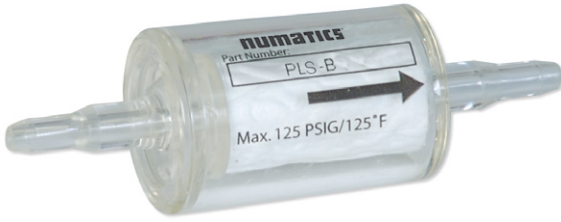

PL Series - Dual Barbed

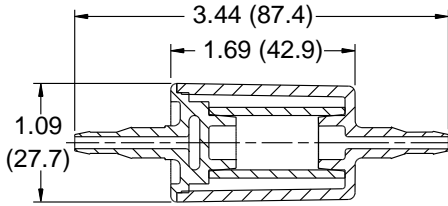

PLS-B pictured



Dimensions in inches (mm)

PL Series - Straight



PLS-T pictured

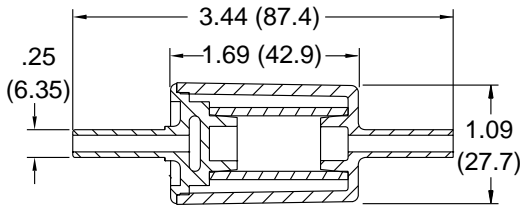

Dimensions in inches (mm)

Features - Dual Barbed and Straight Type

- Max pressure at 125 PSI (8.6 BAR)
- Max temperature at 125°F (52° C)
- Rugged polyurethane housing with dual barb style
- Rugged nylon housing with straight style
- Compatible with many chemicals
- Depth-loading coalescing media provides long life
- Dual barb for 1/4 and 1/8 ID soft tubing
- Straight tang for push-on fittings
- Oil indicating dye – turns red with oil present (See option "D")
- Epoxy element binder – standard – grades R, S, T, U
- Teflon element binder (See option "T")
- Flow outside to inside element (Cap to body)

Applications

- Sensor Protection
- Pneumatic Logic
- Exhaust Muffler
- Medical/ Pharmaceutical
- Instrumentation
- Gas Sampling

Flow Rates for PLS-B

Pressure	PSIG (Bar)	10 (0.7)	20 (1.4)	40 (2.8)	60 (4.1)	80 (5.5)	100 (6.9)	125 (8.6)
*Flow	SCFM (lpm)	1.1 (31.1)	1.3 (36.8)	1.8 (51.0)	2.1 (59.5)	2.4 (67.9)	2.6 (73.6)	2.8 (79.3)

* Based on a 1.5 psid pressure drop

Flow Rates for PLS-T

Pressure	PSIG (Bar)	10 (0.7)	20 (1.4)	40 (2.8)	60 (4.1)	80 (5.5)	100 (6.9)	125 (8.6)
*Flow	SCFM (lpm)	1.6 (45.3)	2.1 (59.5)	2.8 (79.3)	3.6 (102.0)	3.9 (110.4)	4.4 (124.6)	4.9 (138.8)

* Based on a 1.5 psid pressure drop

How to Order

PLS - B D

Series
 PL = Plastic Inline

Element Grades
 R = 0.01 Micron
 S = 0.3 Micron
 T = 0.5 Micron
 U = 1 Micron
 P = 5 Micron (Particulate)
 F = Activated Carbon
 X = Silica Gel

Options (Specify Alphabetically as Required)
 D = Oil Indicating Dye (F, D and C approved)
 T = Teflon Binder Grades R, S, T & U

Port Option
 B = Dual Barbed
 T = 1/4" Straight

** Not available on grades P, F, and X

*** F, D and C = Food, Drug & Cosmetic



Disposable Miniature In-Line Filters

PT Series – Straight Fitting



PTS-B pictured

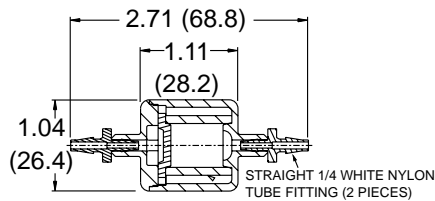

Dimensions in inches (mm)

PT Series – Elbow Fitting



PTS-BN pictured

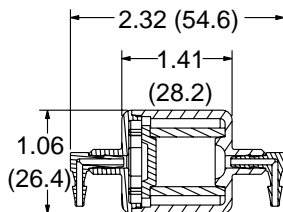

Dimensions in inches (mm)

Features - Straight and Elbow Fitting Type

- Max pressure at 35 PSI (2.4 BAR)
- Max temp at 125° F (52° C)
- Rugged blue tinted nylon housing
- Straight barb option
- Right angle barb option
- Depth-loading coalescing media provides long life
- Element binder is epoxy - Standard for grades R, S, T, U
- Teflon binder optional for elements (See option "T")
- Flow outside to inside element (Cap to body)

Applications

- Protection of miniature pneumatic components
- Exhaust muffler
- Instrumentation
- Sampling devices
- Gas sampling
- Small design areas

Flow Rates for PTS-B

Pressure	PSIG (Bar)	5 (0.35)	10 (0.7)	20 (1.4)	35 (2.4)
*Flow	SCFH (lpm)	19 (9.0)	22 (10.4)	26 (12.3)	34 (16.1)

* Based on a 1.5 psid pressure drop

Flow Rates for PTS-BN

Pressure	PSIG (Bar)	5 (0.35)	10 (0.7)	20 (1.4)	35 (2.4)
*Flow	SCFH (lpm)	17 (8.0)	18 (8.5)	21 (9.9)	23 (10.9)

* Based on a 1.5 psid pressure drop

How to Order

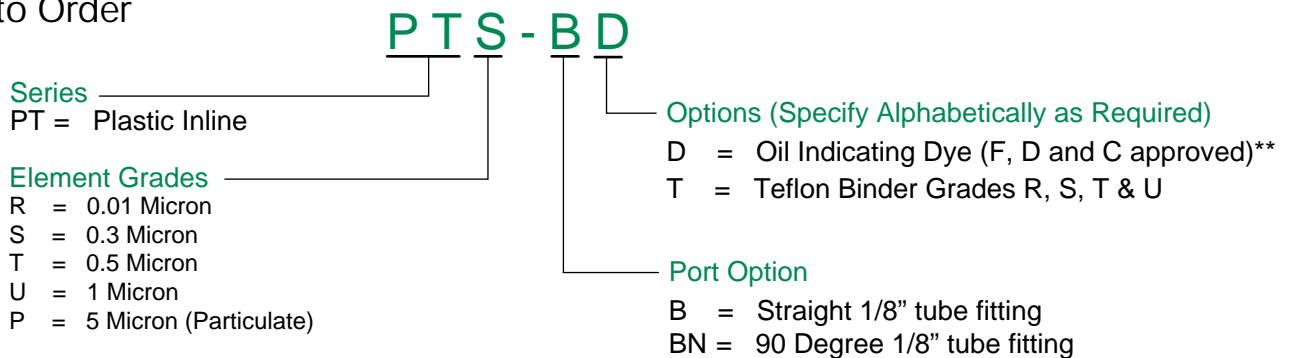

** F, D and C = Food, Drug and Cosmetic



PH Series Filters

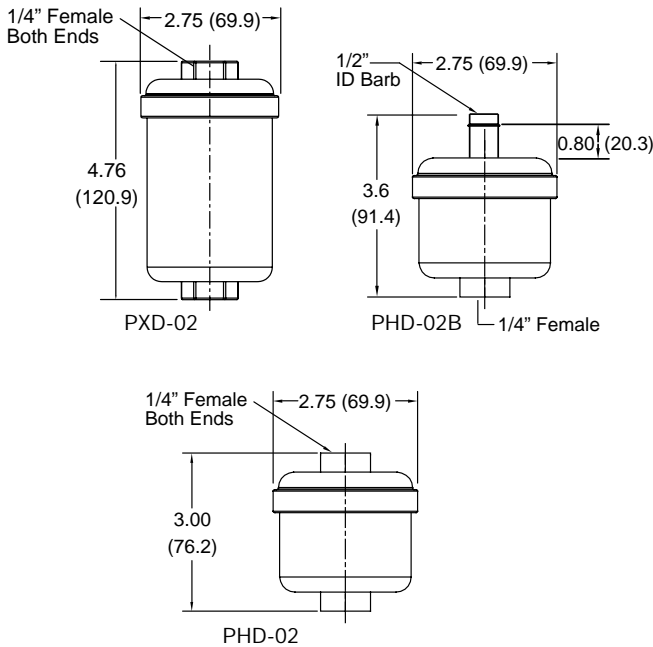

Dimensions in inches (mm)

Features

- Max pressure 100 PSIG (6.9 BAR)
- Max temp 200F (93°C)
- 300F at 60 PSIG 4.1 BAR / 149°C
- Rugged Polyester housing
- Brass inserts
- Inner support core which protects element from collapsing
- Spin welded seal - no adhesives or chemicals
- Thermally bonded end caps on elements
- Extended version for longer filter life
- HEPA - High Efficiency Particulate Air
- ULPA - Ultra Low Particulate Air

Applications

- Medical concentrators
- Intake filter
- After filter for miniature desiccant beds
- High flow pneumatic tools
- Critical instrumentation protection

Flow Rates for PHD

Pressure	PSIG (Bar)	10 (0.7)	20 (1.4)	40 (2.8)	60 (4.1)	80 (5.5)	100 (6.9)
*Flow	SCFM (lpm)	14 (396.4)	17.5 (495.5)	22.4 (634.3)	26.8 (758.9)	30.8 (872.2)	34.3 (971.3)

* Based on a 1.5 psid pressure drop

Flow Rates for PXD

Pressure	PSIG (Bar)	10 (0.7)	20 (1.4)	40 (2.8)	60 (4.1)	80 (5.5)	100 (6.9)
*Flow	SCFM (lpm)	17.5 (495.5)	20.7 (586.2)	26.4 (747.6)	31 (877.8)	35.3 (1000.0)	39.3 (1113.0)

* Based on a 1.5 psid pressure drop

How to Order

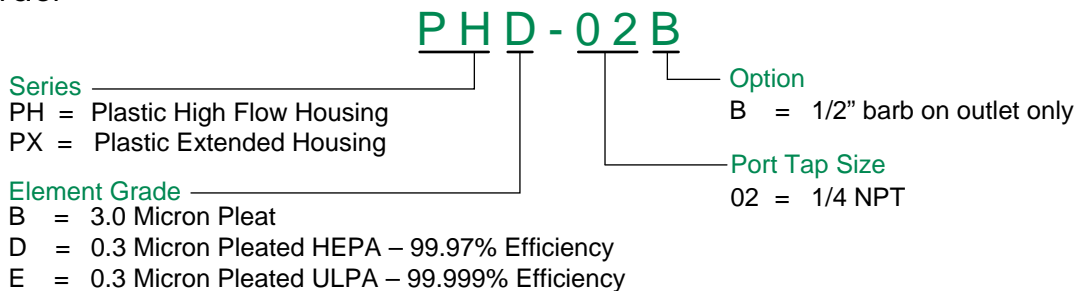



Disposable Miniature In-Line Filters

PH Series Desiccant Dryers



PHS-02
Pictured

Features

- In-Line Desiccant Dryers - 30°F dew point
- Max pressure 100 PSIG (6.9 BAR)
- Max temp 150°F (66°C)
- Rugged clear polycarbonate housing
- Integral 3μ filter paper inlet and outlet – blue silica gel turns pink when saturated indicating replacement
- Brass inserts
- Spin welded seal - no adhesives or chemicals

Applications

- Critical instrumentation protection
- Parts blow off
- Paint spray

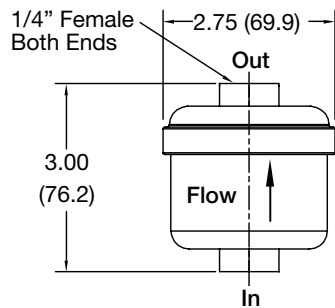

PHS-02

Dimensions in inches (mm)

Flow Rates for PHS

Pressure	PSIG (Bar)	10 (0.7)	20 (1.4)	40 (2.8)	60 (4.1)	80 (5.5)	100 (6.9)
Flow	SCFM (lpm)	5.5 (155.7)	7.0 (198.2)	10.0 (283.2)	12.5 (354.0)	14.5 (410.6)	15.5 (438.9)

* Based on a 1.5 psid pressure drop

How to Order

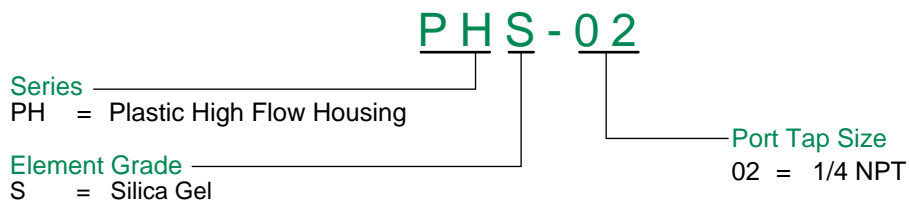

WORLD HEADQUARTERS

USA

Numatics, Incorporated

46280 Dylan Drive
Novi, Michigan 48377

P: 1-888-Numatics
1-888-686-2842

Canada

Numatics, Ltd

P: 519-452-1777

Mexico

Numatics de Mexico S.A. de C.V.

P: 52-222-284-6176

For a comprehensive listing of all Numatics production and distribution facilities worldwide, visit:

www.numatics.com